

8

7

6

5

4

3

2

1

### REVISIONS

EFFECTIVITY	REV	DESCRIPTION	DATE	APPROVED
FUTURE	A	FIRST RELEASE ISSUE	8 / 25 / 14	

#### NOTES:

- MOTOR ASSEMBLY SHOWN WITH SPECIFIED MOTOR HARDWARE & RELOAD KIT.

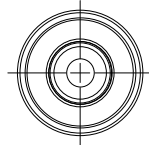
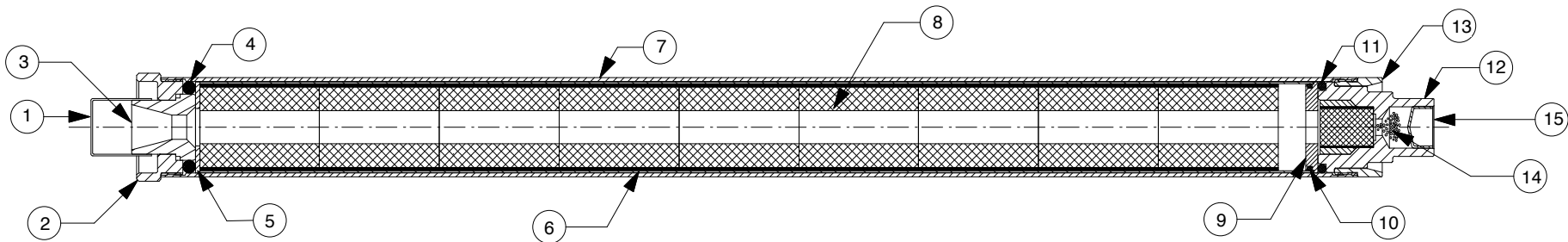

VIEW AFT CLOSURE

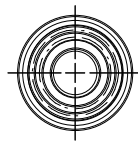

VIEW FORWARD CLOSURE

QTY	PART NUMBER	DESCRIPTION	ITEM
1	0406-5	EJECTION CAPLUG	15
1	05708	EJECTION CHARGE ASSY	14
1	38FCRR	38MM FWD CLOSURE RETAINING RING	13
1	38EZBAW	RMS-EZ FWD BULKHEAD ASSY- WL	12
1	00216	FORWARD O-RING (1 3/8" O.D. X 1/8") 216	11
1	00025	SEAL DISC O-RING (1.313" X 1/16") 025	10
1	38601	FWD SEAL DISC (1.375"O.D.X.5" I.D.X.188")	9
9	03582-3	GRAINS (1.308" O.D. X 1.815" X .500" CORE) 8225SW	8
1	3810C	CASE	7
1	02065-9	PHENOLIC LINER (1.368" O.D. X 16.875")	6
1	05404	AFT INSULATOR(1.375"O.D.X.562" I.D.X1/16")	5
1	00318	AFT O-RING (1.375" O.D. X 3/16") 318	4
1	01550-2	NOZZLE (NEW L2) DRILLED .359"	3
1	38AC2	AFT CLOSURE L2	2
1	041316	NOZZLE CAP (13/16" I.D.)	1

LIST OF MATERIAL			
CONTRACT NUMBER		 <b>2113 W. 850 N. Street</b> <b>Cedar City, Utah 84721</b> <b>(435) 865-7100 (Ph)</b> <b>(435) 865-7120 (Fax)</b>	
PREP	G. ROSENFELD		
CHKR			<b>HP 38/1080 MOTOR WITH J570W-14A</b> <b>RMS-EZ™ RELOAD KIT</b>
APVD			
APVD			SIZE <b>A</b> NUMBER <b>ASSY DWG</b>
SCALE 1/25		SHEET 1 OF 1	

SUPPLIER DATA		RELOAD KIT IDENTIFICATION		UNLESS OTHERWISE SPECIFIED DIMENSIONS ARE IN INCHES		
AEROTECH/RCS RMC INC.		105714	J570W-14A RMS-EZ	.XX +/- .010	.XXX +/- .005	ANGLES +/- 2 deg.
				MATERIAL		
				NOTED		
				FINISH		
		<b>PART NUMBER</b>	<b>DESCRIPTION</b>			

8

7

6

5

4

3

2

1